

isata

E-SERIES



Introducing the new ISATA 230SL

ISATA has always been the brand known for luxury in comfortably-sized, driver-friendly motorhomes. Now the popular line of ISATA Touring Sedans has become even better with the introduction of the all-new ISATA 230SL. This exciting new floor plan features a spacious slide-out to create dramatically more living space.

The ISATA 230SL is one of several new models Dynamax is building on the popular Ford Econoline 450 chassis. All will come equipped with Dynamax's new DynaRide™ Air Suspension system for a remarkably smoother, better ride. The new E-series ISATA Touring Sedans will also offer two attractive new exterior paint colors. And Dynamax will also be introducing a new cab-over option on its 23- and 25-foot floor plans, which will provide an additional bed over the driving area.

The newly designed ISATA E-series. Power, luxury and innovation in an efficient, easy-to-drive package. Exactly what you expect from Dynamax.



KEY DIMENSIONS	230SL
GVWR:	14,050 lb.
GCWR:	20,000 lb.
Overall Length:	23' 11"
Exterior Width:	8' 5"
Wheelbase:	158"
Overall Exterior Height:	10' 1"
<small>(Includes standard 13,500-BTU roof air conditioner)</small>	
Interior Height:	6' 6"
Fuel Capacity:	55 gal.
Water Capacities:	Fresh: 34 gal.
	Grey: 26 gal.
	Black: 25 gal.
LPG Capacity:	20.3 gal./92 lb.

EXTERIOR FEATURES & CONSTRUCTION

Radiused, aerodynamic, fiberglass — laminated sidewalls and ceiling
Molded-fiberglass rear-body cap
R-8 insulation in sidewalls and ceiling
R-11 insulation in floor
Square-tube aluminum-framed sidewall
Heavy-gauge square-tube steel floor trusses
Seamless-fiberglass textured roof
12-volt electric slideout with awning (250SL, 254SL, 280SL, 282SL)
Four semi-automatic leveling/stabilizing jacks (250SL, 254SL, 280SL, 282SL)
Welded aluminum-frame boxes for all through-wall cutouts
Outside, lockable, trunk and side storage compartments with sealed, seamless-molded fiberglass liner and steel reinforcing straps
Sewer-hose storage compartment with locking door
Locking doors for fuel and fresh-water fill
Front, aluminum, billet grille
Automatic, electric entry step
Lighted-entry grab handle
Premium-quality heavy-duty screen door
Tire-valve extensions for rear wheels
Exterior base coat/clear coat, four-color custom-ribbon paint and graphics
Diamond Shield™ paint protection on selected impact areas
Rear mud flaps
30-ft. land line for 110-volt/30-amp external power
City water and gravity-fill hookups
Outdoor shower/cleaning station
Exterior porch and service lights
A&E™ box awning (power awning optional)
Custom-molded front-bumper ground effects with running lights
One-piece fiberglass sun visor
Hydraulic jack and lug wrench
Tow hitch (5,000 lb.) with wire harness
Exclusive DynaRide™ air suspension system

DRIVING COMPARTMENT FEATURES

Steel safety cage surrounding transition from cab to coach
Six-way power driver and passenger captain's chairs
Premium "Soft Touch" upholstery for captain's chairs
Power steering, brakes and windows

Tilt steering column
Power remote and heated mirrors
Rear-view mirror with outside temperatures and compass
Cruise control
Dash, automotive air conditioning
Dash instrumentation: engine temperature, fuel level, odometer, trip odometer, speedometer, oil pressure, voltmeter
Driver and passenger overhead, directional reading lamps
Dash-mounted AM/FM/CD
Tinted glass in windshield, side and rear windows
Intermittent windshield wipers
Power door locks (driver, passenger and entry door)
Remote entry

LIVING SPACE FEATURES

22-in. flat-screen TV and Sony® DVD/CD player with Surroundsound™
Cable TV and phone hookup
Automotive door latch and deadbolt lock on entry door
Premium-quality stain-resistant nylon-sculpted carpet on thick, 2-lb. pad
Low-level aisle lighting with convenience switch at entry door
Panoramic, bonded/tinted crank-out awning-style windows with screen (no sliders)
Solid-oak cabinet fronts and raised-panel doors
Corian® counter tops
Choice of: Cabernet, Tan, Mink, Shadow Stone or Stoney Ridge (Grey) high-style interior-decor packages
Designer-fabric window valances
Mini blinds over kitchen window
Soft, pleated, day/night shades on other windows
Snap-in privacy drape for windshield
Winegard® roof-mounted antenna with manual crank, 360-degree swivel and 12-volt signal booster
Double Corian® sinks
Single-handle pullout faucet/sprayer in kitchen sink
Sink cover to provide additional counter work space in kitchen
Dometic® 8.0-cubic-foot dual-power two-door refrigerator/freezer
Two-burner LP-gas range in black enamel
Lighted power hood over range
Convection/microwave oven
Sofas: Flexsteel® EZ Bed (254SL, 280SL, 282SL) Flexsteel® Hide-A-Bed with air mattress (250SL) Lexington® jack knife (220)
Seat belts for passengers on sofa

Pedestal-mounted sofa table (except where dinette)
Deluxe fabric ceiling
Recessed double-bulb fluorescent ceiling lights over dining and kitchen area
Recessed double-bulb fluorescent light over kitchen sink
Numerous 12-volt incandescent lights
Strategically placed 110-volt outlets
Vanity-style porcelain basin with Delta™ chrome single-lever faucet
Porcelain toilet in bath
One-piece fiberglass shower/surround with folding shower door
Skydome in shower
Mirrors over vanity and in bathroom or closet door
Water-pump switch in bath
Emergency-exit window in rear of vehicle
Safety Features: LPG leak detector, 12-volt carbon-monoxide detector, smoke detector, fire extinguisher

COMFORT CONTROL, ENVIRONMENTAL SYSTEMS

30,000-BTU Suburban® LP-gas furnace with ducted discharge
Ceiling-ducted low-profile Duo-Therm™ roof-mounted 13,500-BTU air conditioner
Insulated air conditioning ducts
Air conditioning vents with controls to redirect air flow and volume
Fantastic® roof vents
Comfort-control center with thermostat and switching for heating and air conditioning
Full-function monitor panel tracks levels of fresh, grey, black water; battery status, LP level; includes switches for water heater, water pump, holding-tank heaters and exterior light
Six-gal. Suburban® LP-gas water heater with direct-spark ignition
4.0 Onan® gas generator
Water-heater bypass valves
Inside battery-cutoff switch for coach
Power inverter — 600 watt

CHASSIS FEATURES

Ford® E450
Ford® 6.8L Triton V-10 engine (415 CID, 305 HP, 420 ft./lbs. of torque @ 3250 RPM)
Dual rear-drive wheels
LT225/75R x 16E tires with full-size spare
55-gallon fuel tank
Four-speed automatic overdrive transmission
Four-wheel ABS brakes: power front disc, rear disc
Front stabilizer bar

1.125" rear stabilizer bar
Rear DynaRide air suspension with adjustable shock absorbers
Front coil spring with shock absorbers
4.56 rear axle ratio
Battery control center to control and manage charging of batteries
Heavy duty chassis/starting battery
Dual auxiliary house batteries
130-amp alternator
Driver and front passenger air bags

OPTIONS

Ford® 6.0L Power Stroke® DI Turbo Diesel V8 engine (235-hp, 440 ft./lbs. of torque @ 2000 RPM)
Back-up camera
GPS navigation system
Heat strip for air-conditioning system
Fully automatic HWH electro-hydraulic leveling system
Cobra® CB radio
Side dinette in lieu of couch on select floorplans
15,000-BTU roof-mounted Dometic® air conditioning
Gerard® power awning
Individual awning for any window
Outdoor entertainment system
8-cu.-ft. Dometic® double-door refrigerator/freezer w/icemaker
10-cu.-ft. Dometic® refrigerator
Cherry/natural-maple cabinets
10-disc CD changer
Heart® interface 2,000-watt power inverter
Bose® Life Style 18 AM/FM/DVD player and Surroundsound®
Fantastic® roof vents with automatic rain sensors
Aluminum-alloy wheels
DSS satellite TV dish
Fully automatic digital in-motion satellite system
Other options are available — contact your ISATA dealer for more information.

WARRANTY

Conversion has a limited warranty for three (3) years or 36,000 miles by Dynamax Corporation.
Chassis has a three (3) year or 36,000 mile warranty by Ford® Motor Company.
Installed appliances and fixtures are warranted by their respective manufacturer.
Ask your dealer to see a copy of the Dynamax warranty for details.

230SL

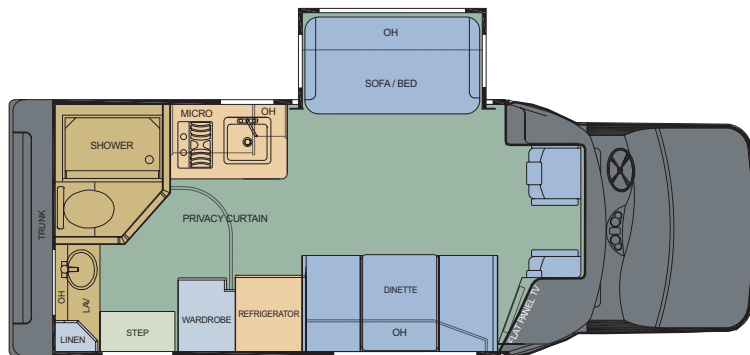

DYNAMAX
CORPORATION

A manufacturer of luxury touring vehicles

2745 Northland Dr • P.O. Box 1948
Elkhart IN 46515
888-295-7859
www.dynamaxcorp.com

Actual towing capacity is dependant on your particular loading and towing circumstances, which includes GVWR, GAWR and GCWR, as well as adequate trailer brakes.

Please refer to the Owners Manual of your vehicle for further information.
Floor plans, features and specifications of the ISATA are subject to change without notice.